

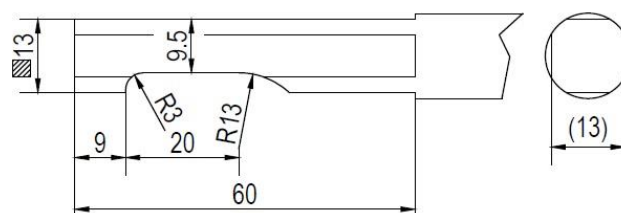

Manufacturer of pneumatic impact tools and hydraulic tools for mines, quarries, construction industry, steelworks and foundries.

TECHNICKÉ ÚDAJE – TECHNISCHE DATEN – TECHNICAL DATA



SEK MD16

PNEUMATIC CHIPPING HAMMER

APPLICATION

The chipping hammer is a versatile tool. It is used in construction work (light chipping and breaking, slotting, cleaning), foundries (degating castings, removing risings) and in stonework (wedging, cutting of inscriptions, sculpture, etc.).

Technical data and main dimensions	ISO Unit	SEK MD16
Weight	kg	1,6
Impact energy	J	1,5
Impact rate	Hz	73
Air consumption	m ³ min ⁻¹	0,25
Operating air pressure	MPa	0,3 – 0,6
Effective value of weighted acceleration	m.s ⁻²	4,6
Sound power level Lp	dB(A)	93
Length	mm	227
Supply hose	mm	Js 10
Piston Diameter x Piston Stroke	mm	15 x 35
Connecting thread		G 3/8" (D)
Tool shank size	mm	SQ13/AC-RRC13
Ordering code		D160001

www.permon.cz
e-mail : prodej@permon.cz
e-mail : export@permon.cz

Roztoky 217, 270 23 Křivoklát, Česká republika

pro ČR, SR - for the Czech Rep. and SK

pro ostatní země - für andere Gebiete - for other territories

T: + 420 313 521 567

T: + 420 313 521 563

v: 3.2022